

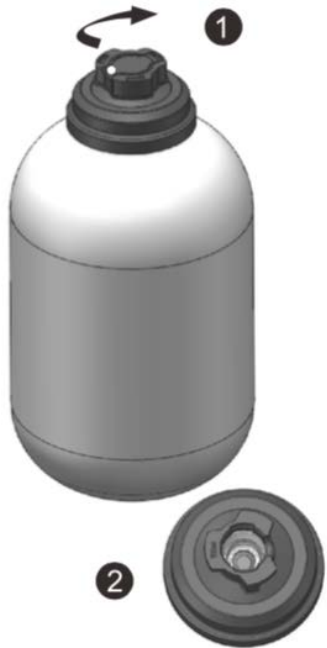

3L Keg Top Dispenser Use Instructions

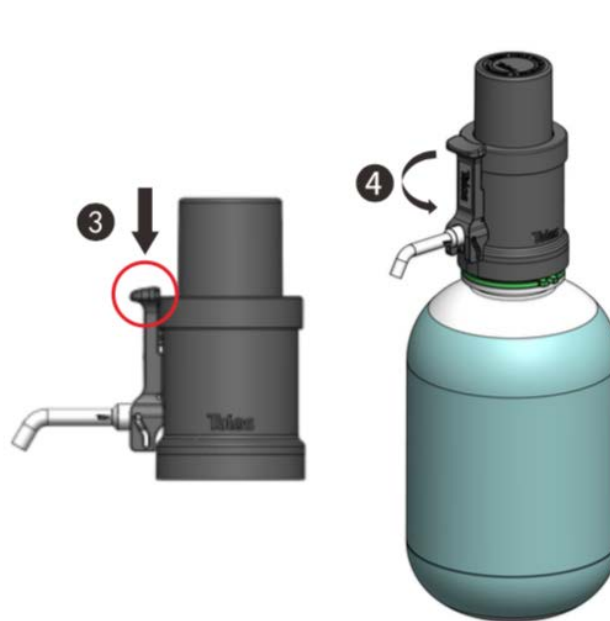

1. Remove the keg's dust-proof cap.
2. Disinfect the keg head with alcohol.



3. Press the handle lever to turn off the spout.
4. Connect the dispenser to the keg and screw clockwise to lock the dispenser.



5. Press the dispenser head to supplement pressure, pull the handle lever to turn on the spout and pour.
6. Turn counterclockwise to remove the dispenser. The dispenser can be rinsed directly with clean water.